



Voxello Software Update Instructions

Major changes and reason for this update:

The noddle-chat update version 2.12, which includes the 'bailout option' when scanning rows, is now available.

The 'bailout option' alleviates the issue of the user having to click all the way down the list of rows to get back to a row/individual icon they meant to select. The user can now navigate to the 'bailout' button at the end of a row if they missed an icon and go back to the start of the row.

To update your tablet:

1. Make sure your tablet is connected to WiFi.

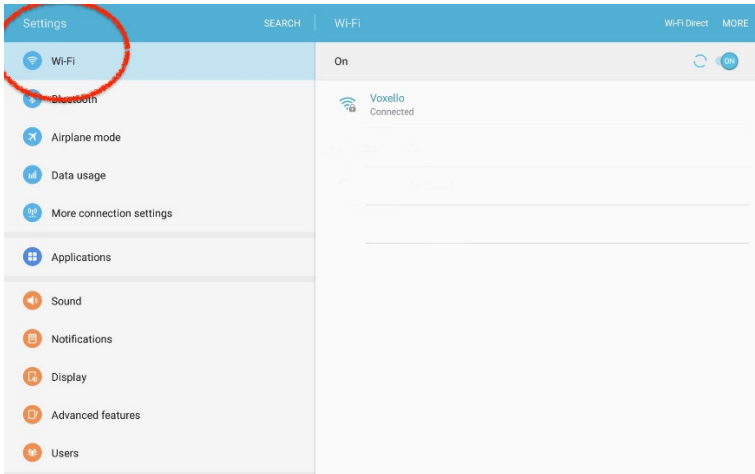

2. In the noddle-chat app, select the menu button on the tablet so the menu bar appears.

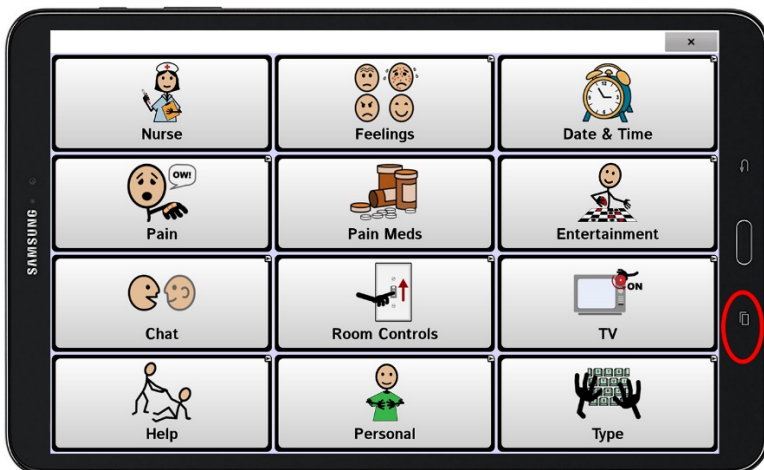

3. Select "Help" on the far right of the menu bar.



4. Under Help, select "Check for updates..."

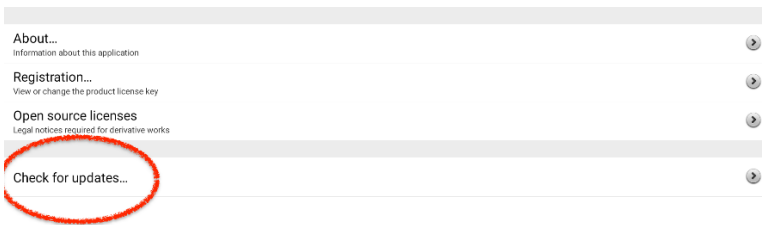

5. It should automatically scan for the latest update (2.12) and from there you can update your tablet by clicking "Install Now".

2.10.0 → 2.12.0



Last Check: Mar 13, 2018 4:25 PM
Last Update: Mar 13, 2018 4:24 PM

Lastly, create a New User to finish the update:

1. In the noddle-chat app, select the menu button on the tablet so the menu bar appears.

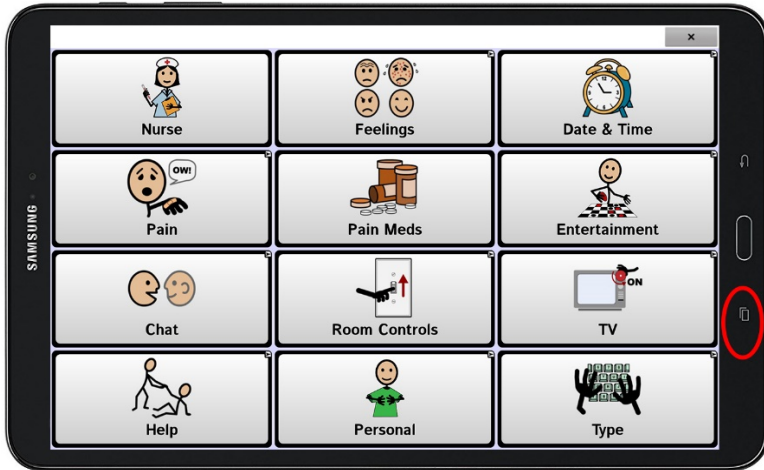

2. Select "Settings" on the menu bar.



3. Under Settings, select "System"

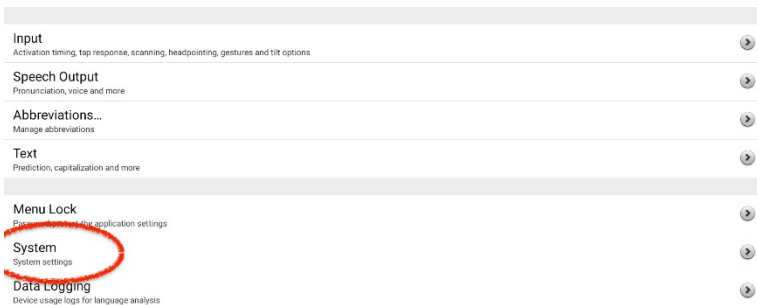

4. Under System select "New User".

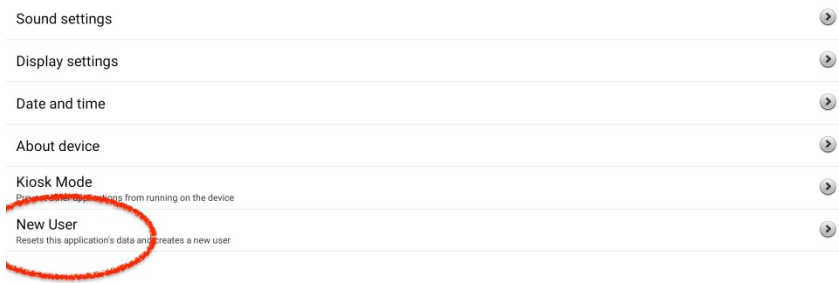

5. This will prompt you to delete existing user data, select "Yes".

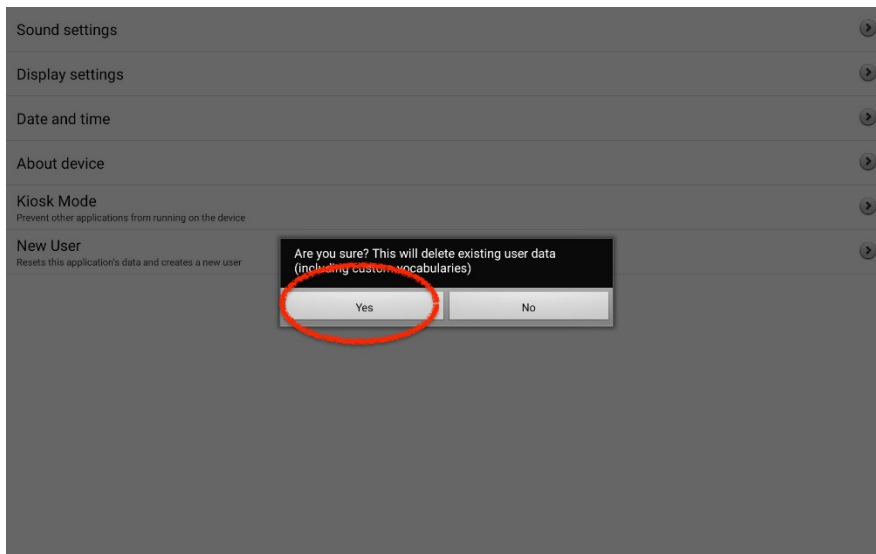

6. From here, you can choose the desired user profile. This will display the updates.